



MARTIAL COTTLE PARK



LEGEND

- Ranger Station/Visitor Center
Phone: (408) 355-2299
 - Entry Kiosk & Pay Station
 - Parking
 - Gate
 - Restrooms
 - Picnic Area
 - Reservable Group Picnic Area
 - Paved Road
 - Park Road (Bicycles OK)
 - Service Road (No Public Access)
 - Trail Distance (miles)
 - Creek
 - Private Property
 - Future Use Area (No Public Access)
 - Agriculture Area (Lessee & Invitee Access Only)
- TRAIL USE**
- Hiking
 - Paved Hiking
 - Hiking / Equestrian / Bicycling
 - Paved Hiking/Equestrian/Bicycling

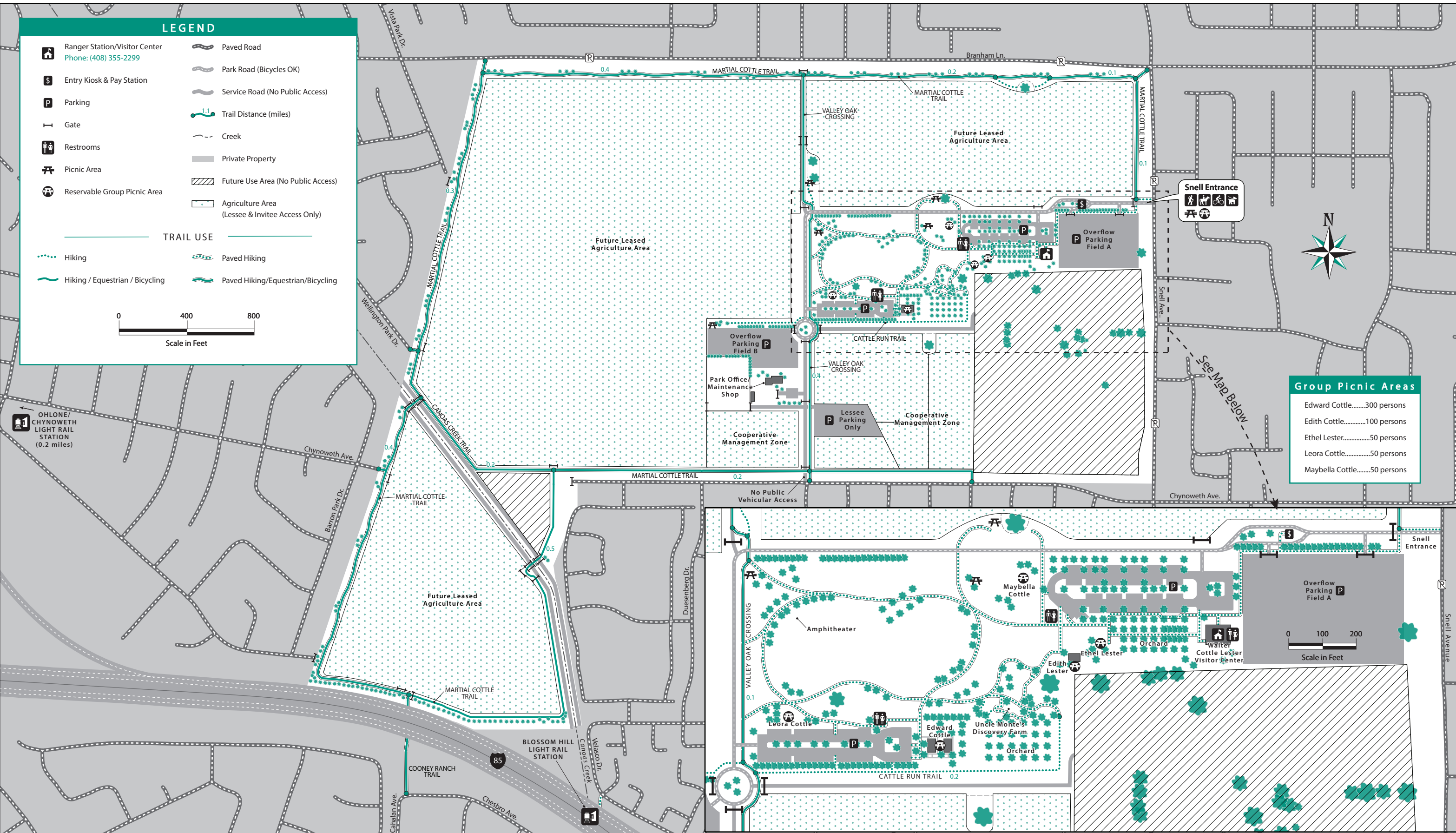
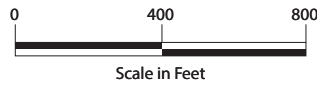

Group Picnic Areas

- Edward Cottle.....300 persons
- Edith Cottle.....100 persons
- Ethel Lester.....50 persons
- Leora Cottle.....50 persons
- Maybella Cottle.....50 persons

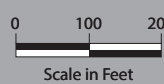

OHLONE/CHYNOWETH LIGHT RAIL STATION (0.2 miles)

BLOSSOM HILL LIGHT RAIL STATION

See Map Below